



Produktmerkmale

- = Kompakte Konstruktion und geringes Gewicht
- = Temperatur: -10 °C - +160 °C
- = für Luft, Wasser, Gas und Öl
- = lieferbar mit L- oder T-Bohrung
- = Volldurchgang
- = Antistatic-Ausführung

Prüfungen

- = Prüfung nach Regeln der Technik
- = Nachweis gemäß EN 10204-3.1 für Werkstoffe und Druckprobe
- = alternativ nach EN 10204-3.2

Zertifiziert nach

- = DIN ISO 9001 / EN 29001
- = Feuersicher nach B.S. 6755 Teil 2
- = Bauteilkennzeichen VdTÜV
- = TA-Luft 3.1.8.4.

Product Features

- = compact design and low weight
- = temperature: -10 °C - +160 °C
- = suitable for air, water, gas and oil
- = L- or T-bore available
- = full bore
- = anti static

Testings

- = testing acc. to technical requirement
- = corresponding certificate acc. to EN 10204-3.1 for material and pressure test
- = alternatively acc. to EN 10204-3.2

Certified according to

- = DIN ISO 9001 / EN 29001
- = Fire safe acc. to B.S. 6755 part 2
- = Component mark VdTÜV
- = TA-Luft 3.1.8.4.

Durchflussrichtung / Flow direction

L-Bohrung / L bore

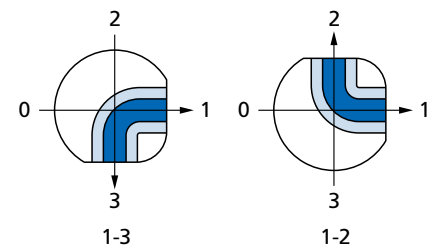

T-Bohrung / T bore

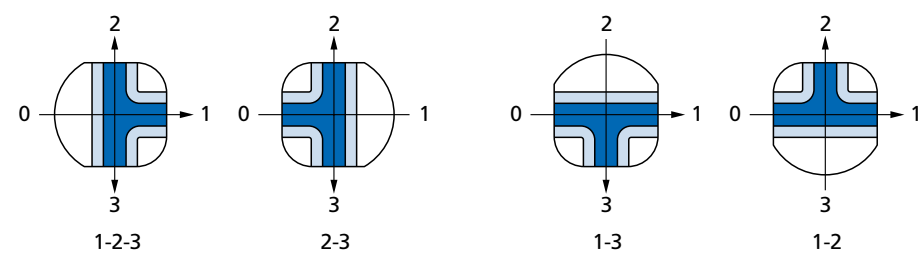

DN 40 - DN 125

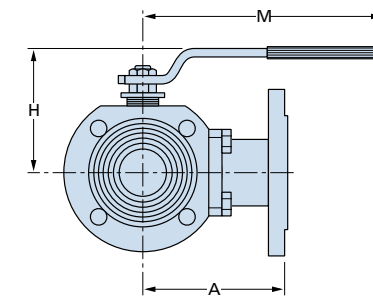
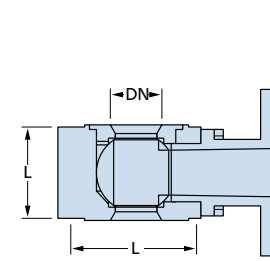

DN 150 - DN 200

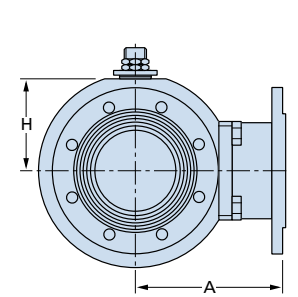
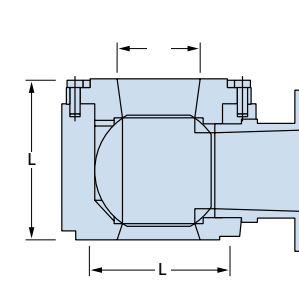

Abmessungen [mm] und Gewichte [kg]

Dimensions [mm] and weights [kg]

| DN | 15 | 20 | 25 | 32 | 40 | 50 | 65 | 80 | 100 | 125 | 150 | 150 | 200 |
|------------------|-----|-----|-----|-----|-----|-----|-----|-----|-----|-----|-----|-----|-----|
| R" | ½ | ¾ | 1 | 1¼ | 1½ | 2 | 2½ | 3 | 4 | 5 | 6 | 6 | 8 |
| L | 40 | 40 | 50 | 55 | 65 | 80 | 108 | 118 | 152 | 175 | 264 | 290 | 292 |
| A | 85 | 90 | 90 | 105 | 120 | 130 | 150 | 175 | 185 | 200 | 230 | 230 | 270 |
| H | 64 | 78 | 84 | 121 | 125 | 126 | 150 | 158 | 178 | 193 | 214 | 214 | 270 |
| M | 153 | 153 | 185 | 253 | 253 | 280 | 380 | 380 | 455 | 455 | 455 | 455 | 700 |
| Gewicht / Weight | 2,4 | 3,5 | 4,5 | 7 | 9 | 13 | 22 | 29 | 39 | 55 | 90 | 95 | 110 |

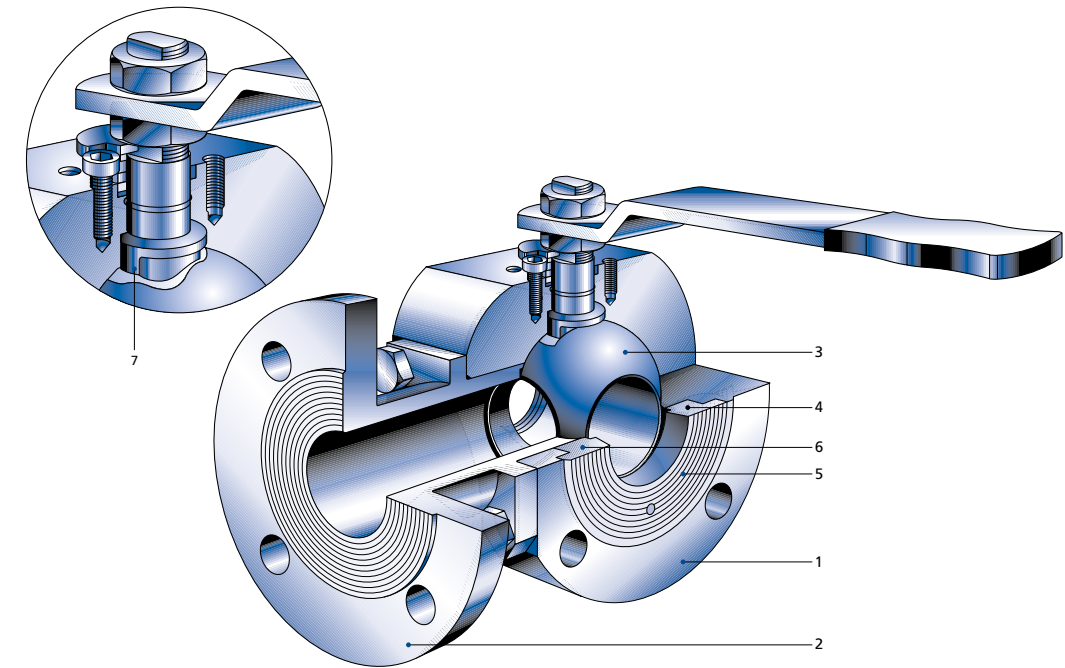

| Teil / Part | Benennung / Designation | Werkstoff / Material | | 1) | 2) |
|-------------|-------------------------------|----------------------|-----------------------------|----|----|
| | | Stahl / Steel | Edelstahl / Stainless steel | | |
| 1 | Gehäuse / Body | C22.8 | X5CrNiMoNb 18-10 | | |
| 2 | Gegengehäuse / End | C22.8 | X5CrNiMoNb 18-10 | | |
| 3 | Kugel / Ball | X5CrNi 18-9 | X5CrNiMoNb 18-10 | = | = |
| 4 | Gehäusedichtung / Insert seal | PTFE / Graphit | PTFE / Graphit | = | = |
| 5 | Einschraubring / Insert ring | C22.8 | X5CrNiMoNb 18-10 | | |
| 6 | Kugeldichtung / Ball seal | PTFE | PTFE | = | = |
| 7 | Schaltwelle / Stem | X5CrNi 18-9 | X5CrNiMoNb 18-10 | = | = |

1) Empfohlene Ersatzteile / Recommended spare parts

2) Verschleißteile / Parts subject to wear